

Why Data Centre Infrastructure At ENGINEER & MARVEX?

In the dynamic landscape of Malaysia's growing data centre industry, ENGINEER & MARVEX is spearheading a crucial conversation on the future of technology infrastructure.

Malaysia Is Projected To Lead The Data Centre Market



Malaysia Data Centre Market Growth and Demand



14% CAGR from USD 1.81B in 2023 to **USD 3.97B** in 2029.

Government Support



Malaysia approved **RM114.7B** in data centre investments from 2021 – 2023.

Geographical Benefits



Malaysia's strategic location strengthens its appeal as a regional data hub, offering excellent connectivity and market access.

Tier 3 Data Centres Dominate Malaysia Market

3x

With IT load capacity set to **triple** by 2029 at a **17.07% CAGR**.

Green Lane Pathway



Friendly policies streamline data centre power approvals, reducing lead times to just **12 months**.

Strong Confidence in Market Potential



Major brands like **Google**, **AWS**, **Microsoft** and more are establishing data centres in Malaysia.

Sources:

1. Google to Invest US\$2 Billion in Malaysia's Data Centre and Cloud Market on ASEAN Briefing.com
2. Malaysia Approved RM114.7 Bln Investments in Data Centre, cloud Services from 2021 to 2023 on Bernama.com
3. Malaysia is emerging as a data center powerhouse amid booming demand from AI on CNBC.com

LIVE SHOWCASE

DATA CENTRE INFRASTRUCTURE

ENGINEER & MARVEX 2025 will prominently feature the Data Centre Infrastructure Live Showcase as a key theme, highlighting **six specialised zones** dedicated to essential components of data centre infrastructure.

This highlight offers exhibitors a unique platform to connect with key stakeholders, showcase innovative technologies, and participate in discussions on advancements in the field.

SERVER ZONE

UPS ZONE

CONTROL CENTRE ZONE

AHU ZONE

MICRO DATA CENTRE ZONE

MAINTENANCE & ACCESSORIES ZONE

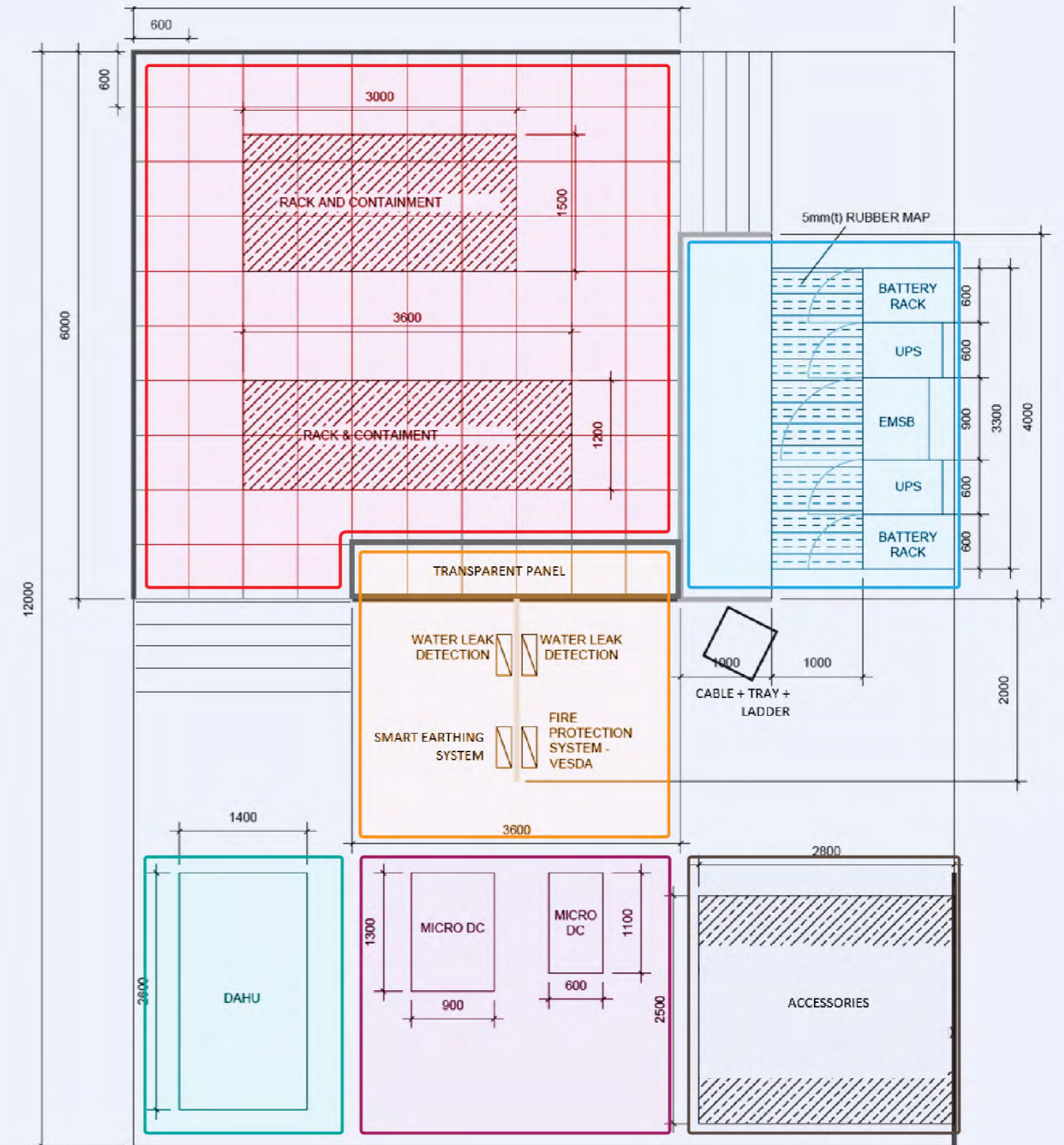

Disclaimer. This drawing reflects the ENGINEER 2024 layout, is not to scale, and is subject to change for the 2025 collaboration.